

Horsell Walks B3 Horsell Birch to Deep Pool and Meadows

Horsell Birch to Viggory Lane; Horsell Common Grasslands to Deep Pool and Chobham Road/Mimbridge; cross to Mimbridge Meadows and leave Horsell Common via Sandy Track Car park; return via Cheapside.

Time: 100 minutes, Distance : 4 miles

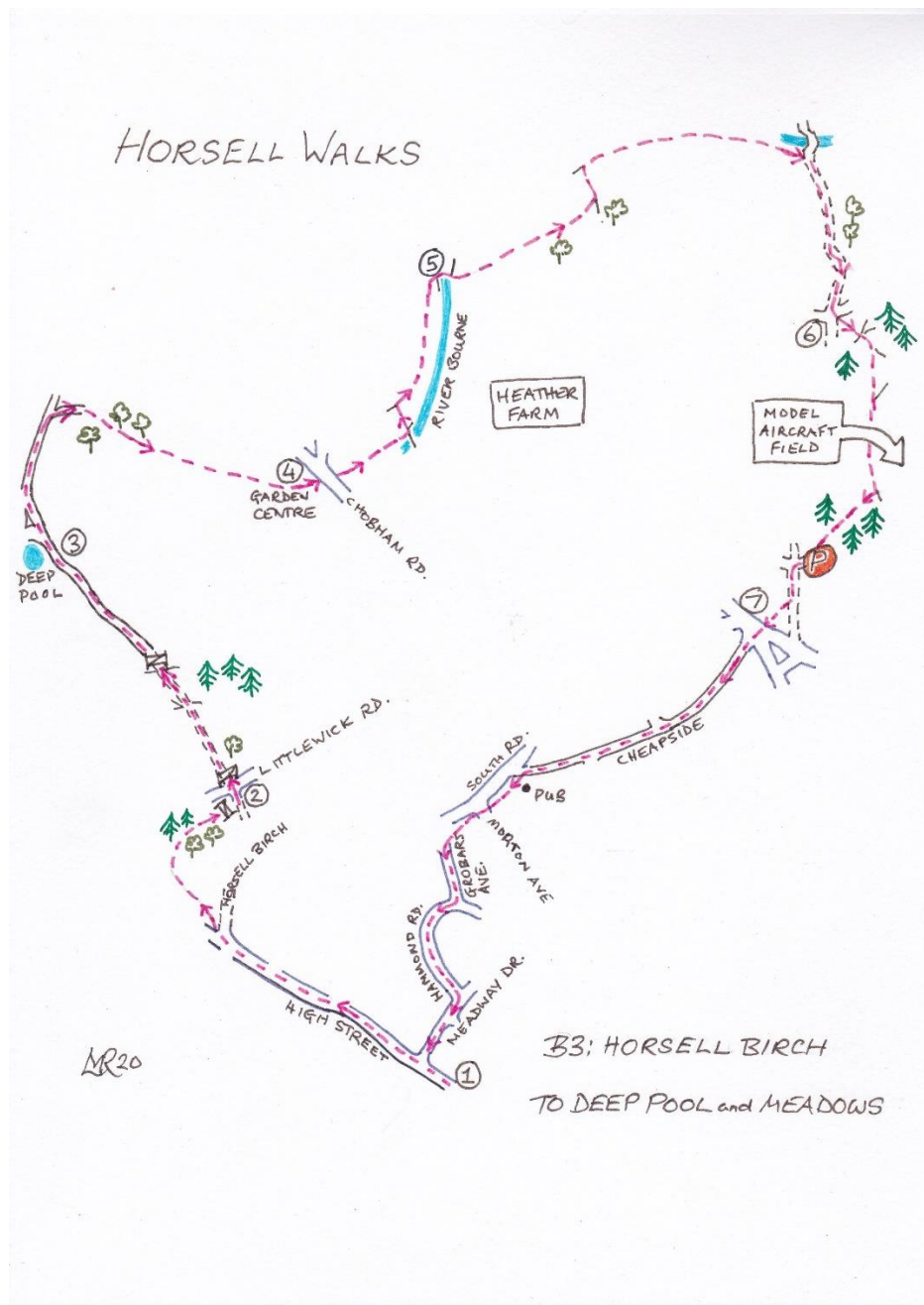

1. Horsell High Street to Littlewick Road: Facing the Village Notice Board, set off to your right, past Seymours, crossing several roads until you reach Horsell Birch. Cross the unmade road onto the grassy area and go into the woodland opposite via a double gated area (passing a Dog Waste Bin on your left). Follow the path (ignoring small path on right) and bear right into an open area. Continue until you reach another double gate and join the end of Viggory lane. Turn Left.

2 Grasslands, Horsell Common to Deep Pool. Cross Littlewick Road with great care and continue straight on through double gates. Go straight ahead with a scraped area on your left where soon the heather will be growing. Possibly you will see the Belted Galloway cattle grazing here. Continue straight until you reach another set of double gates. Go through onto a dark, broad track with trees overhead which eventually bears slightly left then right, crosses a stream on a plank bridge, past farmland to Deep Pool. Here there is a signpost and several houses.

3. Deep Pool to Chobham Road and Mimbridge: Bearing right, almost straight on, continue on the track, go through a gate until you reach a footpath sign on right FP number 120 and turn right here onto a footpath into woodland. Shortly there is a waymarker post and follow this taking the left fork. After a short distance, at the next fork, keep right. Then continue straight across a track. The footpath wiggles a bit and the trees need brushing aside at times but soon the footpath comes out on the busy Chobham Road at Mimbridge.

4. Mimbridge Meadows Turn right and as you get to Long Acres Garden Centre, stop, and cross road to a gap in the fence opposite where there is a new boardwalk bridge into the meadows. Walk straight and into the next meadow when you will meet the path from Heather farm carpark. Keep on the left side of the meadow and follow the path until it comes to the wooden bridge across the River Bourne.

5. Bourne Fields to Young Stroast Lane: Cross the bridge and continue straight on along the board walk, through a hedge and keep going until you come to a second gap in the hedge by an oak tree. Turn left and follow round the line of the meadow. After some distance, the grassy path eventually comes to a kissing gate by a ford and bridge across the river. (do not cross the bridge) Go through the kissing gate and turn right away from the bridge onto a wide track (Young Stroast Lane). Continue until there is a junction with another track in both directions and look across and opposite ever so slightly veering to the left there is a small footpath into the trees.

6. To Sandy Track Car Park: Continue straight avoiding the first footpath on the right (after 100m) and ignore little paths on left. There is a fork where the path is quite narrow. Turn right onto the narrow footpath, through gorse and then it opens out with heather all round. Keeping straight on this will lead to the former model aircraft field, very open area with short grass with heather on the right. Continue straight ahead and then make for the woodland on your right where you will see a path. Turn right onto path in woodland and follow round eventually to the left where you will emerge into the Sandy Track Car park. Turn right into Car park then immediately left onto the main track for 100m. When you are almost at the end of this track and can see the Shores Road, take a narrow footpath on the right which brings you to the crossing on Chobham Road.

Last revision: 17/8/2020

7.Cheapside to Horsell High Street: This is a double crossing needing great care: one-way traffic then 2-way traffic. Once across, turn right then left onto Cheapside. Follow Cheapside, past The Plough and keep on the narrow footpath past the bungalows, continue after crossing Morton Ave and the FP comes into Grobars Ave. Turn left and then go right into Hammond Road across the green island and follow round to left, and turn right into Meadway Drive. You soon reach the High Street where you turn left back to your starting point.